



# Chaval Response-XRT Heated Gloves with ALPHAHEAT™ and ACTIVEDRY™

# INSTRUCTIONS FOR USE

For your safety and the safety of those around you, please read these use guidelines carefully before using your gloves. Failure to adhere to these guidelines can result in serious injury and loss of property.

## HOW TO USE THE CONNECTOR COVER

**WARNING:** If your gloves are operated with the connectors exposed, it is possible for the electronics to endure significant stresses if the connection is pushed or pulled. The connector cover protects the connection; eliminating the potential for these stresses to occur and ensuring that the performance of your gloves is not accidentally compromised. To learn how to use the cover, follow the sequence of illustrations in Figure 1 to 5.

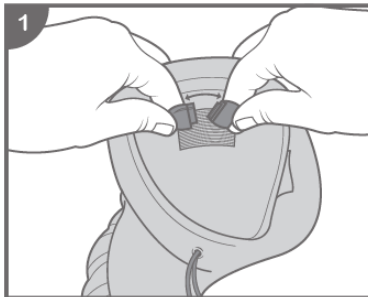

**Figure 1:** Hold the glove, gripping each connector as shown

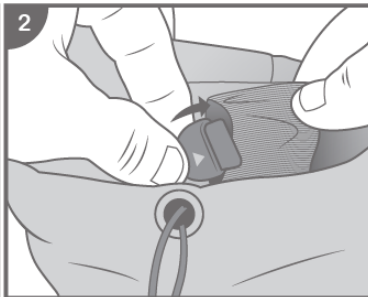

**Figure 2:** Grab and pull the right side of the cover to open the left side of the cover

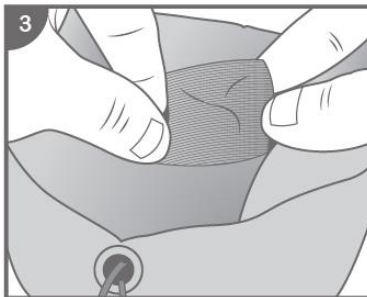

**Figure 3:** Insert the left connector into the cover

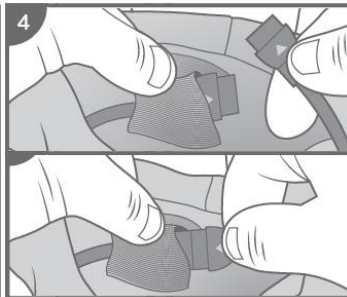

**Figure 4:** Pull the left side of the cover to open the right side, exposing the connector head; make the connection

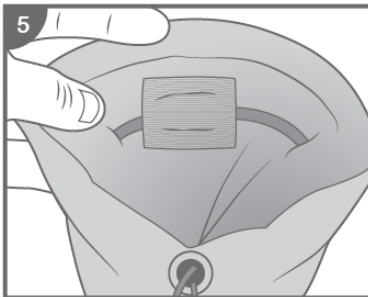

**Figure 5:** Connection completed



# Chaval Response-XRT Heated Gloves with ALPHAHEAT™ and ACTIVE DRY™

# INSTRUCTIONS FOR USE

For your safety and the safety of those around you, please read these use guidelines carefully before using your gloves. Failure to adhere to these guidelines can result in serious injury and loss of property.

## CHARGING WITH ACTIVE DRY™ CHARGER

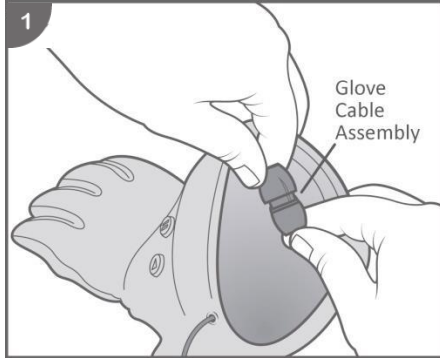

**Figure 1:** The cable assembly that contains the glove charging plug is located just inside the interior glove cuff

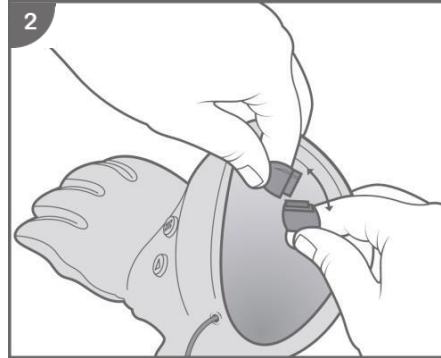

**Figure 2:** Hold only the plug heads when disconnecting the glove charging plug from the glove cable assembly

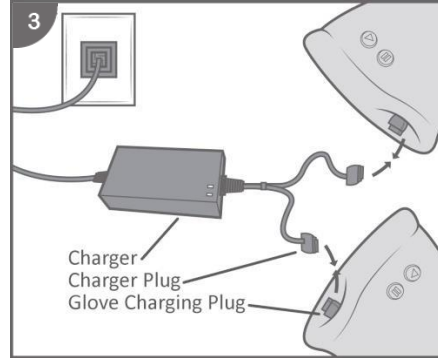

**Figure 3:** Connect each glove charging plug to a charger plug to automatically start the charging process

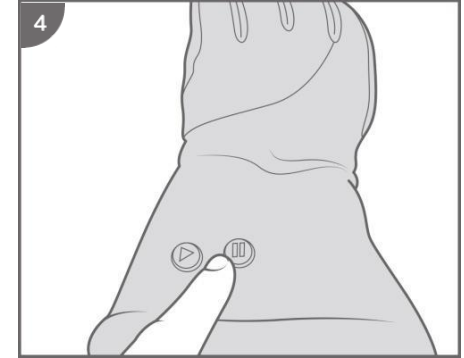

**Figure 4:** Press 'Play' to activate & 'Pause' to deactivate

Fully charge your gloves before first use. Most pairs are fully charged before shipment.

1. The cable assembly that contains the glove charging plug is located just inside the interior glove cuff (Figure 1). You must disconnect the glove cable assembly to charge the gloves. When disconnecting the glove charging plug from the glove cable assembly (Figure 2), hold only the plug heads, not the cables.

2. Plug the ACTIVE DRY™ charger (Figure 3) into an electrical outlet. The charge indicator lights on the charger will illuminate green.

3. Connect the glove charging plugs on both gloves to the two charger plugs (Figure 3). The charging process will automatically start and the charge indicator lights will turn red (unless the gloves are already fully charged). At the same time, the ALPHAHEAT™ system in each glove will activate to accelerate the drying process.

4. To maximize the effectiveness of the drying process:

Open the gauntlet cuff and elevate the cuff above the fingers to allow the warm wet air from inside of the glove to escape. If this is not done, moisture will be trapped in the fingertips.

Do not set anything on top of the gloves while charging.

Do not set the gloves on top of each other while charging.

About 8 hours are required to fully recharge discharged gloves.

When the gloves are 90-95% charged, the charge indicator lights will turn green and the ALPHAHEAT™ heating system will deactivate, but the gloves will continue to trickle-charge up to a full charge.

Do not allow the gloves to remain connected to a powered charger more than 24 hours.

5. Disconnect both glove charging plugs from the charger plugs.

6. Line up the plugs in each glove's cable assembly and reconnect them (Figure 1).

Recharge the gloves after each use to protect the battery system and ensure your gloves are ready for use.

Store and transport the gloves with the glove cable assembly plugs disconnected to ensure the gloves are not activated and the batteries not unintentionally drained.

The proprietary lithium polymer battery system in these gloves does not need to be fully discharged before recharging.

**WARNING:** Do not place the charger in a confined space. Ensure that the charger is well ventilated. The charger must dissipate a large amount of heat and will become hot during the charging process. Do not try to open the gloves to gain access to the battery system. It is a closed, proprietary system with no replaceable parts. Do not expose the gloves to an open flame. Improper handling of lithium polymer batteries can cause them to explode!

## USE

The 'Play' and a 'Pause' buttons (Figure 4) are used to turn the heating system on and off. The 'Play' button will illuminate to indicate the system is active and heating.

**Activate:** Press the 'Play' button momentarily to turn on the heating system. The 'Play' button will illuminate.

**Regulation:** The automated heat regulation adjusts with ambient conditions, your hand temperature and other environmental factors.

**Deactivate:** Press the 'Pause' button momentarily to turn off the heating system. The illuminated 'Play' button will de-illuminate.

**WARNING:** Use the heating system only in cold conditions. If used indoors or in warm conditions, the heat could become excessive. Avoid overheating your hands. If your hands are becoming sweaty or overheated, turn the system off until needed again.



# Chaval Response-XRT Heated Gloves with ALPHAHEAT™ and ACTIVEDRY™

# INSTRUCTIONS FOR USE

For your safety and the safety of those around you, please read these use guidelines carefully before using your gloves. Failure to adhere to these guidelines can result in serious injury and loss of property.

## HOW TO ATTACH THE LANYARD

Utilization of a glove lanyard will help to ensure that you never accidentally drop your gloves. To attach the lanyard, follow the sequence of illustrations in Figure 1 to 4.

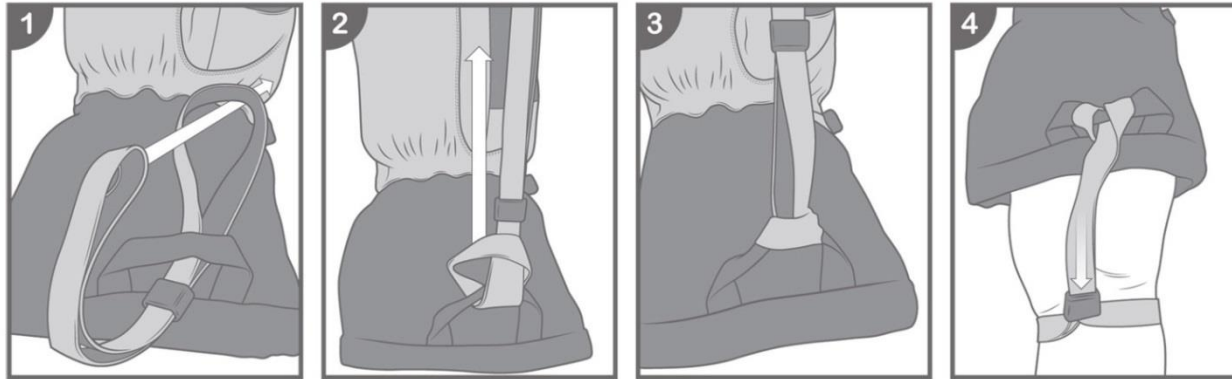

**Figure 1, 2, 3:** After inserting the lanyard through the glove pull strap, feed one end through the open loop of the other end, then pull to tighten the attachment

**Figure 4:** Insert hand through the end of the lanyard, tighten it around the wrist, then don the glove

## SAFETY PRECAUTIONS

If you have difficulty sensing hot or cold objects (e.g. diabetics, disabled persons, Raynaud's, etc.), please consult your doctor before using these gloves.

Not for use by children.

Use only the supplied charger to charge the gloves.

Check your fingers regularly for reddening of the skin. Excessive heating over prolonged periods can lead to burns.

The drying temperature must not exceed 60 °C (140 °F). Do not dry Response-XRT gloves on a heater or in clothes dryers.

Do not wear the gloves during the charging process.

Do not insert any foreign object into connecting sockets or plugs as this could damage the heating system.

Stop using the unit if you discover any damage to the connecting cables, battery system or other parts. If you are unsure if your glove is safe for use, contact Chaval Outdoor for clarification.

Do not crush, twist, impact or pierce a glove with sharp objects. If this occurs, discontinue use of the glove immediately.

Do not make any modifications to the unit or use it for any unintended purposes. Repairs to the unit or its connecting plugs are only to be carried out by the manufacturer.

If you have any questions or concerns, please contact Chaval Outdoor.

## CLEANING

Dirty gloves can be cleaned using a damp cloth. The gloves should never be washed in a washing machine or be immersed in water.

## STORAGE AND CARE

The Response-XRT contains a proprietary lithium polymer battery system and can be charged in any state. It is unnecessary to fully discharge the batteries before charging.

Do not leave the gloves connected to the charging system for more than 24 hours.

Store and transport the gloves with the glove cable assembly plugs disconnected to ensure the gloves are not activated and the batteries not unintentionally drained.

Do not store gloves fully discharged. If discharged, charge for about 3 hours before storage. Store them in a cool, dry room (from 5 °C [41 °F] to 20 °C [68 °F]).

In case of long-term storage, recharge the gloves every 6 months for about 3 hours. Proper storage of the gloves maximizes battery performance and durability.

Do not crush, twist, incinerate, short circuit, dismantle or immerse in liquids.

## DISPOSAL

Dispose of gloves and packaging in an environmentally-responsible way and in accordance with local regulations. Do not dispose of electrical equipment in unsorted municipal waste. Recycle all electronics at the appropriate collection or recycling center. By recycling, you help protect the environment and public health. Please contact your local authority for more information.

## REPAIR

Repair of your gloves can be facilitated by contacting Chaval Outdoor: [customerservice@ChavalUSA.com](mailto:customerservice@ChavalUSA.com)

## TECHNICAL DATA

**Charger Input:** 100 – 240 V (50-60 Hz)

**Charger Output:** 2 x 4.2 V / 1 A

**Proprietary Lithium-Polymer battery system:** 3.7 V / 3900 mAh

## MAX. TEMPERATURE\* PER CHARGE

62 °C (144 °F) for 6 hours

\* Measured on the heating element under laboratory conditions. The length of time the heating system will produce heat depends on weather conditions, user's physiology & system charging level.

**WARNING:** Chaval Outdoor Corporation is not responsible for the consequences, whether direct, indirect, or accidental, or for any other type of damage arising or resulting from the use of its products. You are responsible for your actions and activities and for any consequences that may result from them.